

# BECCA®

## INSTRUCTION MANUAL

S10A



Spray Gun Cleaner

Patent Pending



- Warranty
- Safety
- Operation
- Service Parts
- Troubleshooting Guide
- Accessory Information

**TABLE OF CONTENTS**

	<u>PAGE</u>
<b>WARRANTY INFORMATION .....</b>	<b>3</b>
<b>SPRAY GUN CLEANER SPECIFICATIONS .....</b>	<b>4</b>
<b>SAFETY AND WARNING .....</b>	<b>5</b>
General Safety .....	5
Danger and Warning Labels .....	5
General Safety Rules .....	6
Personal Safety .....	6
Unit Use and Care .....	7
Safety Rules .....	7-8
<b>INTRODUCTION .....</b>	<b>9</b>
<b>OPERATION GUIDELINES .....</b>	<b>9 – 11</b>
<b>TROUBLESHOOTING GUIDE .....</b>	<b>12</b>
<b>MAINTENANCE SCHEDULE .....</b>	<b>13</b>
<b>SCHEMATIC OF UNIT .....</b>	<b>14 - 18</b>
<b>PARTS DESCRIPTION .....</b>	<b>19</b>
<b>WARRANTY INFORMATION / TECHNICAL ASSISTANCE .....</b>	<b>20</b>



## LIMITED WARRANTY

Solvent Recyclers & Paint Gun Washers

### 24 MONTH LIMITED WARRANTY

BECCA Solvent Recyclers and Spray Gun Cleaners components are warranted to be free of defects in material or workmanship for 24 months from established purchase date to the original user or from original shipment whichever is sooner. During months 1 through 12 BECCA will repair or replace any component including labor that is found to be defective in material or workmanship as determined by BECCA factory certified service technician. For months 13 through 24 BECCA will furnish parts only (no travel, diagnostic or repair labor is provided) to replace any component that is found to be defective in material or workmanship as determined by BECCA factory certified service technician. In all cases defective parts shall be returned to BECCA for inspection and final approval.

There is no other express warranty, implied warranties, including those of merchantability and fitness for a particular purpose, are limited to one year from purchase and to the extent permitted by law and all implied warranties are excluded. This is the exclusive remedy and liability for consequential and incidental damages under any and all warranties are excluded to the extent exclusion is permitted by law.

### CONDITIONS OF WARRANTY

BECCA has no control over working conditions, solvents involved in usage and under which purchaser stores, handles or uses BECCA product. We make no warranty or condition, either expressed or implied with respects to usage or mistreatment of product. These warranties apply only to the original purchaser and do not apply if the unit has been misused, subjected to overloading, neglect, accident, altered or used for any other purpose. BECCA shall not be liable for loss, damage or delay due to, without limitation, acts of God, transportation delays, accident, fire, action of civil or military authority, adverse weather or any other causes beyond BECCA's control. This warranty does not cover transportation, interior or exterior finishes. The use of unauthorized chemicals or solvents with acid content in this unit shall render this warranty null and void. BECCA shall not be responsible or liable for any consequential or incidental damages, including without limitation, loss of production or faulty production, loss of use or loss of profit. Attempts at repair or alterations by the owner shall also constitute a violation of this warranty. Only BECCA certified personnel shall start-up, train, repair or alter BECCA equipment. Spray Gun Cleaner Brushes, Filters, and Gun Clips & Solvent Recycler Gaskets/Seals, Oil, and Bags are subject to be replaced due to normal usage, wear and tear within the warranty period and are excluded from this warranty.

These warranties replace all other warranties expressed or implied by nature or otherwise, and are not assignable or transferable from original purchaser.

***Warranty is in effect after receipt of Registration information & full payment***

2010 Cobb International Blvd Ste H Kennesaw, GA 30152	Phone 1-800-655-5649	Fax 1-800-655-5684
---	----------------------	--------------------

Revision 1/8/05

## SPRAY GUN CLEANER SPECIFICATIONS

### SPECIFICATION FOR S10A POWER CLEAN™ HANDS-FREE SPRAY GUN CLEANERS

SPECIFICATIONS	U.S. UNITS	METRIC UNITS
Weight	87 Lbs.	39.5 Kg
Height	41.5"	1054 mm
Width	18.5"	470 mm
Depth	23.5"	597 mm
Wash Basin Height	15"	375 mm
Wash Basin Depth	20"	300 mm
Wash Basin Width	12"	300 mm
Solvent Capacity of Container (2)	5 Gallons	20 Liters
Diameter of Exhaust Chimney	4"	100 mm
Air Consumption at 50 psi / 8 Bar	8 – 15 cfm	.0038-.0054 cms
Capacity of Spray Guns per Wash	2	2
Air Supply Operating Pressure	50 psi.	4 – 5 Bar
Acoustic Pressure Level LpAm ISO-3746	68.4 dB(A)	68.4 dB(A)
Acoustic Power Level LpAm ISO-3746	79.2 dB(A)	79.2 dB(A)
Pump	Single diaphragm	Single diaphragm
Pump Capacity	4 Gal/min	15 Liters/min
Groundable containers	2 (Optional)	2 (Optional)
Outside Frame steel	Ultra Powder Paint	Ultra Powder Paint
Wash Basin and work table	Stainless steel	Stainless steel
Warranty- Limited	24 months	24 months

## SAFETY AND WARNING

### GENERAL SAFETY

1. Carefully inspect the shipping carton for any signs of transport damage. The damage to the carton often indicates possibility of transport damage to the equipment inside.
2. Carefully remove your BECCA Spray Gun Cleaner from the shipping carton.
3. Check your equipment immediately to ensure that it is free of transport damage. Report any transport damage to the carrier without delay for possible claim procedures. BECCA Inc. is not responsible for damage to equipment after it leaves our warehouse.
4. Check the equipment list and compare it with the parts you have received. If any parts are missing, contact the supplier you purchased the equipment from.

**Before operating the BECCA SPRAY GUN CLEANER, read this Instruction Manual completely. All BECCA products are engineered and manufactured to the highest performance standards and have been subjected to detail testing before shipment from the factory.**

### DANGER AND WARNING LABELS

#### DANGER



1



2



3



4

#### WARNING



5

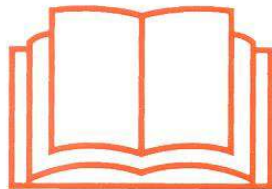

6



7



8

1. Presence of flammable vapors and solvents.
2. No smoking or metal grinding nearby.
3. Keep away from open flames.
4. Wear Breathable Air during use.

5. Observe warnings at all times.
6. Read the Instruction Manual carefully.
7. Wear solvent-proof rubber gloves.
8. Wear protective eyewear before use.

## SAFETY AND WARNING (cont'd)

### WARNING

« READ ALL INSTRUCTIONS » Failure to follow the SAFETY RULES identified by a BULLET (°) symbol listed BELOW and other safety precautions may result in serious personal injury. « SAVE THESE INSTRUCTIONS »

### GENERAL SAFETY RULES

- **KEEP WORK AREA CLEAN.**
- **KEEP CHILDREN AWAY.** Do not let visitors come in contact with the equipment. All visitors should be kept away from the work area.

### PERSONAL SAFETY

- **GUARD AGAINST ELECTRIC SHOCK.** Prevent body contact with grounded surfaces, for example: pipes, radiators. Solvent resisting rubber gloves and non-skid footwear is recommended where damp or wet ground may be encountered. A ground fault circuit interrupter protected power line must be used for these conditions.
- **DRESS PROPERLY.** Do not wear loose clothing or jewelry. They can be caught in the moving parts. Wear protective hair covering to contain long hair.
- **USE SAFETY EQUIPMENT. WEAR SAFETY GOGGLES** or glasses with side shields.
- **STAY ALERT. USE YOUR COMMON SENSE.** Concentrate on what you are doing. Do not operate the unit when you are tired or under the influence of drugs.
- **DO NOT OVERREACH.** Keep proper footing and balance at all times.
- **BEFORE CONNECTING THE UNIT** to an air line outlet, be sure the pressure is the same as that specified for the Spray Gun Cleaner. An air-line with pressure greater than that specified can seriously injure the user – as well as damage the Spray Gun Cleaner. If in doubt, DO NOT connect the unit. Using an air-line with pressure more than the pressure specified is harmful to the pump.

## SAFETY AND WARNING (cont'd)

### UNIT USE AND CARE

- **DO NOT FORCE THE UNIT.** It will perform better and safer at the rate for which it was designed.
- **THE USE OF ANY OTHER ACCESSORIES** not specified in this manual may create a hazard.
- **DISCONNECT THE UNIT**, before servicing.
- **DO NOT ALTER OR MISUSE THE UNIT.** These units are precision built. Any alteration or modification not specified is misuse and may result in a dangerous situation.

Only trained repairmen should attempt (°) ALL REPAIRS, electrical or mechanical. Contact the nearest Becca repair service facility. Use only Becca replacement parts, any other parts may create a hazard.

### SAFETY RULES

- **THE OPERATOR MUST WEAR** protective solvent-proof rubber gloves to prevent contact between his hands and the products used for washing.
- **THE OPERATOR MUST WEAR** protective eyewear to prevent spatter from coming in contact with his eyes.
- **THE SPRAY GUN WASHER** is designed exclusively to wash spray guns and small objects.
- **STAY ALERT** at the start of the cleaning cycle. Make sure the solvent is not «corrosive». Immediately stop washing and replace the solvent whenever you note signs of corrosion on the worktable.
- **IF EYES COME IN CONTACT WITH SOLVENTS** rinse thoroughly with water.
- **BEFORE USING** the Spray Gun Cleaner, make sure that all safety devices are in perfect operating condition.
- **BECOME FAMILIAR WITH THE CONTROLS** and their functions before commencing work.
- **USE GROUNDABLE CONTAINERS (Containers, solvents are supplied in, are recommended)** for the collection of solvents.
- **BE CAREFUL** when you load or unload the solvent in the unit. Make sure you do not splash or spill the contents on the workshop floor.
- **THE OPERATOR MUST PERIODICALLY** check the level of the dirty solvent contained in the collection pail to prevent it from overflowing.

## SAFETY AND WARNING (cont'd)

- **IT IS STRICTLY FORBIDDEN** to place unsuitable sized object or objects that weigh more than 18 Lbs. / 8 Kg on the work surface of the Spray Gun Cleaner.
- **DO NOT USE ELECTRICAL OR PNEUMATICAL TOOLS WITH THE UNIT. AVOID GASEOUS AREAS.** Do not operate portable electric tools in explosive atmospheres in the presence of flammable liquids or gases. Motors in these tools normally spark, and do not scrape or scratch the machine with metal objects; the sparks might ignite fumes.
- **DO NOT ALLOW FAMILIARITY GAINED FROM FREQUENT USE OF YOUR SPRAY GUN WASHER TO BECOME COMMONPLACE.** Always remember that a careless fraction of a second is sufficient to inflict severe injury.
- **DO NOT ALTER OR MISUSE THE UNIT.** Any alteration or modifications is a misuse and may result in serious personal injuries.
- **FIRE EXTINGUISHING SYSTEMS** must be installed in the same room or close to the unit in case of emergency. These appliances must be kept efficient and inspected every year by a certified person.
- **THE INSTALLATION SITE MUST PERMIT PERSONNEL TO EASILY AND QUICKLY MOVE AWAY FROM DANGER ZONES IN CASE OF AN EMERGENCY.**
- **DO NOT USE THE UNIT TO** wash or degrease objects designed to come in contact with food.
- **COMPLY WITH LAWS IN THE COUNTRY** where the Spray Gun Cleaner is installed regarding the use and disposal of the products used to wash clean objects.

THINK SAFETY! SAFETY IS A COMBINATION OF THE OPERATOR'S COMMON SENSE, KNOWLEDGE OF THE SAFETY AND OPERATING INSTRUCTIONS AND ALERTNESS AT ALL TIMES WHEN THE UNIT IS BEING USED.



## INTRODUCTION

This Instruction Manual provides installation, operation and maintenance instructions for the S10A Hands-Free Spray Cleaner unit, which shall be referred to as Spray Gun Cleaners in the following pages. Spray Gun Cleaners are totally pneumatic units designed for Hands-Free cleaning spray guns and small parts.

It is very practical, time saving and economic for cleaning Spray Guns and small parts. The unit is supplied with one (1) pneumatic pump that selects the **CLEAN SOLVENT** from one container and the **USED SOLVENT** from another container. Both containers are located in the base of the unit. The solvent that you will use will depend on the type of paint that you are using. The manufacturer of the paint will give you the information you need regarding this.

This manual is an integral part of the product. It must be properly stored, kept in good condition and available for consultation at any time during the entire working life of the Spray Gun Cleaner. Proper washer operation, economy and durability depend on common sense and compliance with the instructions given in this manual.

## OPERATION GUIDELINES

**Read the following sections carefully. They will help you use your Spray Gun Cleaner correctly and help you select the correct function for your task.**

### Description of the valves

- **a:** CLEAN & USED Solvent Valve
- **b:** Wash Basin Security & POWER CLEAN Valve

### Description for using the Spray Gun Cleaner unit

- The first step in learning to use the Spray Gun Cleaner is to become familiar with the unit. The cleaner basically consists of one (1) pump and two (2) containers of **CLEAN SOLVENT** and **USED SOLVENT**. Operations are carried out via the controls placed on the top & front panel which the operator can control the use.
  - a** – The wash basin clean or used valves has two (2) functions. When set on the used position, it will take the solvent from the used solvent pail. When set on the clean position, it will take the solvent from the clean solvent pail. Both pails are located at the bottom of the washer.
  - b** – The “Security Valve” has several functions: giving air to the pump and to the POWER CLEAN™ line, assuring no flow of solvent to the Basin until the security valve has locked the lid.

## OPERATION GUIDELINES (cont'd)

**IMPORTANT: DO NOT POUR LEFTOVER PAINT INTO THE WASHING BASIN.**

### How to clean spray guns in the Hands-Free Wash Basin

- Start by removing the cup from the spray gun, empty the cup's residues into a separate pail.
- Connect the POWER CLEAN coil hose disconnect (female) to the spray gun disconnect (male).
- You can wash two (2) paint guns and their accessories simultaneously. The first step is to install the Trigger clip on the spray gun. Start by pulling the trigger backward and install the Trigger clip (18) on the trigger. The gun trigger must remain open. The extended nozzle (14) in the Gun Washer is where the fill port for the Gun should be placed.
- Connect the POWER CLEAN™ (red coil hose) quick disconnect (female – not supplied) to the spray gun quick disconnect (male – not supplied)
- Place the cups upside down onto the spraying nozzles (19) or any other accessories to be washed.
- Close the washing basin door and turn on the security valve (d). Set the Solvent Selection Valve (a) to the **USED SOLVENT** position. After a few minutes (or as long as you like) set the Solvent Selection Valve (a) to the **CLEAN SOLVENT** position for a few seconds (4 to 8).
- **Never open the cover when the unit is washing!** Wait until you have put the valve (c) to the off position. Then you can turn off the security valve (d) and open the cover.

### Water Wash

- Spray guns can also be washed with water. In this case, however, the water must be demineralized and have special additives to prevent corrosion on the spray guns.

### Solvent Transfer System

- When the **USED SOLVENT** container has been used for several washings, it has to be transferred into the **SOLVENT SAVER™ Recycler** to be recycled. **Open** the **loading valve** located on the recycler and setting the Solvent Selection Valve to **USED SOLVENT**, the pump will transfer the used solvent from the Gun Cleaner pail to the recycler. Stop when the solvent level in the boiler is about ½ inch below the bag-retaining ring. **Do not overfill.**

For instructions pertaining to the recycling of solvent refer to the **SOLVENT SAVER™ Recycler** Instruction Manual.

When the **CLEAN SOLVENT** container becomes empty, exchange it with the one in the recycler compartment.

- Starting the distillation cycle will refill the container again and again.

## OPERATION GUIDELINES (cont'd)

### Identification of the Hands-Free Spray Gun Cleaner

Every spray gun cleaner has an identification plate that indicates:

- Manufacturer brand
- Manufacturer name and address
- Spray washer model and serial number

Information on this identification plate must always be specified when asking for service and/or spare parts.

### Periodical check and maintenance

Please follow the rules and regulations listed below to safely maintain the Spray Gun Cleaner:

- Periodically make sure that safety devices are complete and efficient.
- Periodically clean the working surface and the cover from any eventual deposits.
- It is strictly forbidden to remove or tamper with safety devices.
- According to the instructions given in this manual, only qualified and specialized personnel must perform maintenance on the Spray Gun Cleaner.
- Disconnect the compressed air supply when it is necessary to repair or perform maintenance on the appliance.
- Maintenance must be performed carefully, following the instructions given in this manual for replacing damaged or worn parts.
- The symbolic labels attached to the Spray Gun Cleaner give clear guidelines for preventing accidents. These labels must always be kept clean and immediately replaced if they are even partially removed or damaged. It is strictly forbidden to operate the Spray Gun Cleaner when even only one of these symbolic labels is missing from the point where the Manufacturer placed it.
- Always use **BECCA GENUINE REPLACEMENT PARTS** during repair and maintenance.

## TROUBLESHOOTING GUIDE

PROBLEM	CAUSE	SOLUTION
Pump is not operating	<ul style="list-style-type: none"> <li>- Main Air is not on.</li> <li>- Air gage shows less than 40psi.</li>   <li>- No sound coming from pump.</li> <li>- Pump is pumping but no solvent is flowing.</li> </ul>	<ul style="list-style-type: none"> <li>- Connect Main Air</li> <li>- Make sure air gage is operating correctly. Adjust pressure.</li> <li>- Pump should be replaced – possible broken actuator spring</li> <li>- Review solvent lines to assure they are in the containers Make sure containers have solvent Make sure the Control Valves are operating. Look for solvent flowing through the lines. Look for aeration in lines – There is a leak somewhere</li> </ul>
Pump is very slow	<ul style="list-style-type: none"> <li>- Sluggish or sporadic.</li> </ul>	<ul style="list-style-type: none"> <li>- Make sure containers have solvent. Make sure air gage is not jumping around below 40psi. Look for aeration in lines – There is a leak somewhere. Assure the Strainer is not clogged</li> </ul>
Solvent is not flowing from the USED and/or CLEAN when the valve is operated	<ul style="list-style-type: none"> <li>- Pump is not operating.</li> <li>- Pump is operating and nothing is flowing.</li> </ul>	<ul style="list-style-type: none"> <li>- See “Pump not Operating” section.</li> <li>- Check to see if flow is working for either USED or CLEAN – If both are not and pumps are pumping review the valve. If one is working and the other is not review the Pump not Operating” section.</li> <li>- Security Pilot Valve may be malfunctioning – Call for Service</li> </ul>
Solvent will not transfer to the Recycler	<ul style="list-style-type: none"> <li>- The Solvent is not moving.</li> </ul>	<ul style="list-style-type: none"> <li>- Check to assure the valve is in the On position. Confirm valve operation by blowing air through the line from the Gun Washer.</li> </ul>

## MAINTENANCE SCHEDULE



### Each day

- Wipe-down the unit with solvent. The paint and decals are solvent resistant.
- Remove any contaminants from the bottom of the Grill

### Semi-Annually

- Clean or replace "Used Solvent" Container (ECP-5 GAL)
- Replace BECCA Protect™ Maintenance Coating (ECP 831004)
- Review Ground Clamps (823079)

### Annually

- Complete Semi-Annual checks
- Replace POWER CLEAN™ red coil hose (824609) if required
- Review & Replace illegible or damaged Decals

SCHEMATIC OF UNIT



S10A

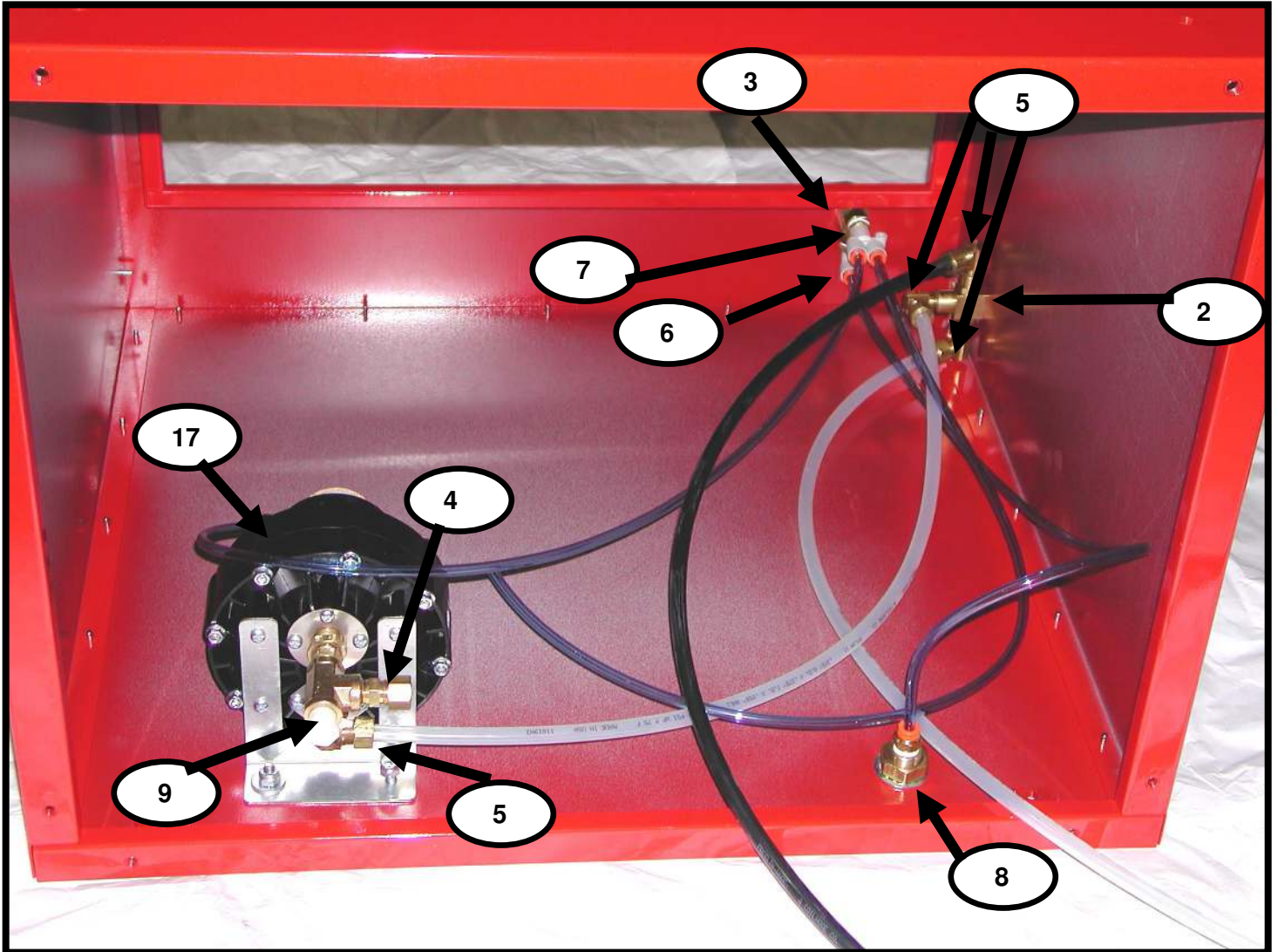



**SCHEMATIC OF UNIT (continued)**

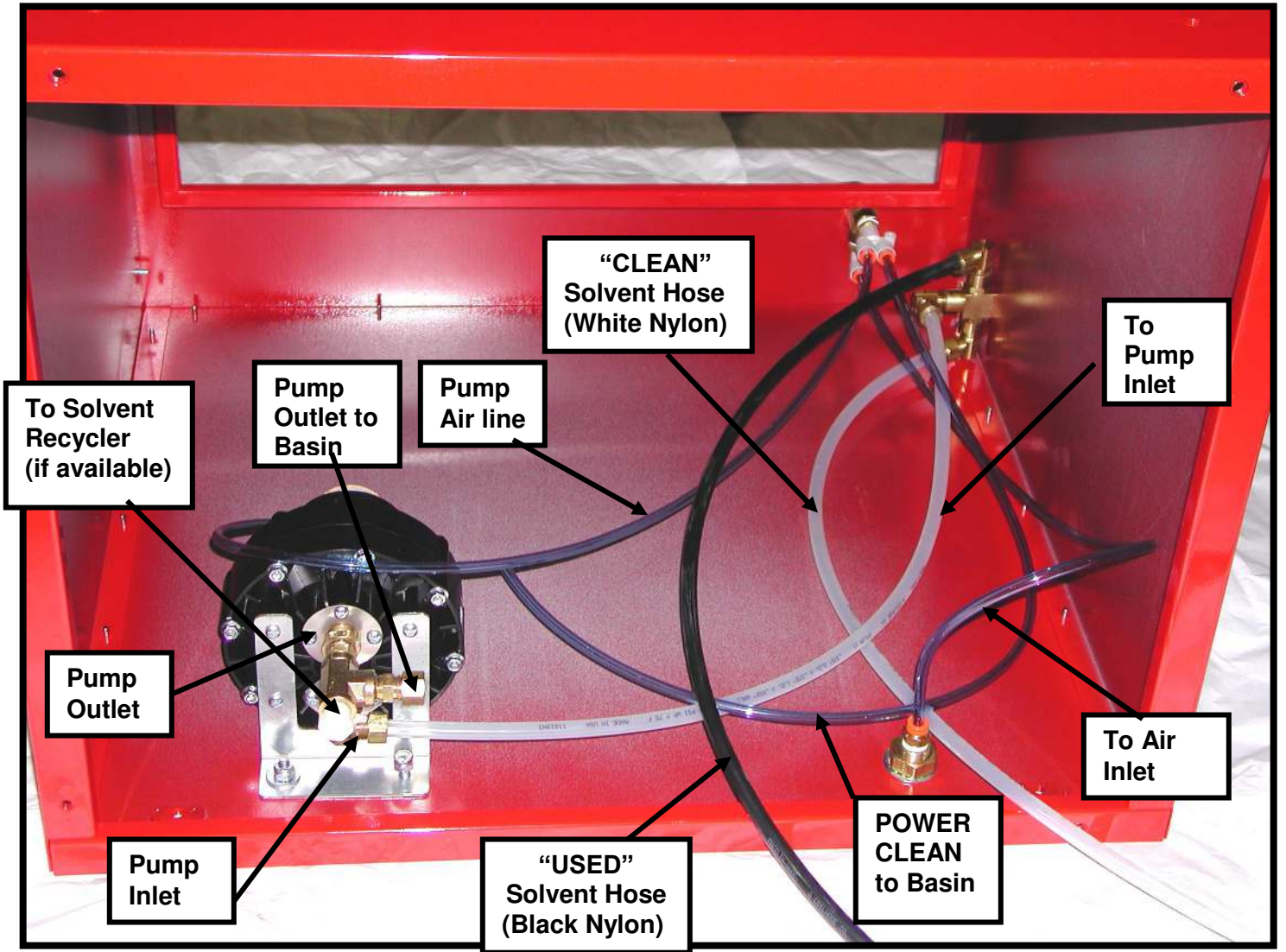

**LEGEND**

 Air - Blue Polyurethane Tube

 Solvent - White or Black Nylon Tube



**SCHEMATIC OF UNIT (continued)**

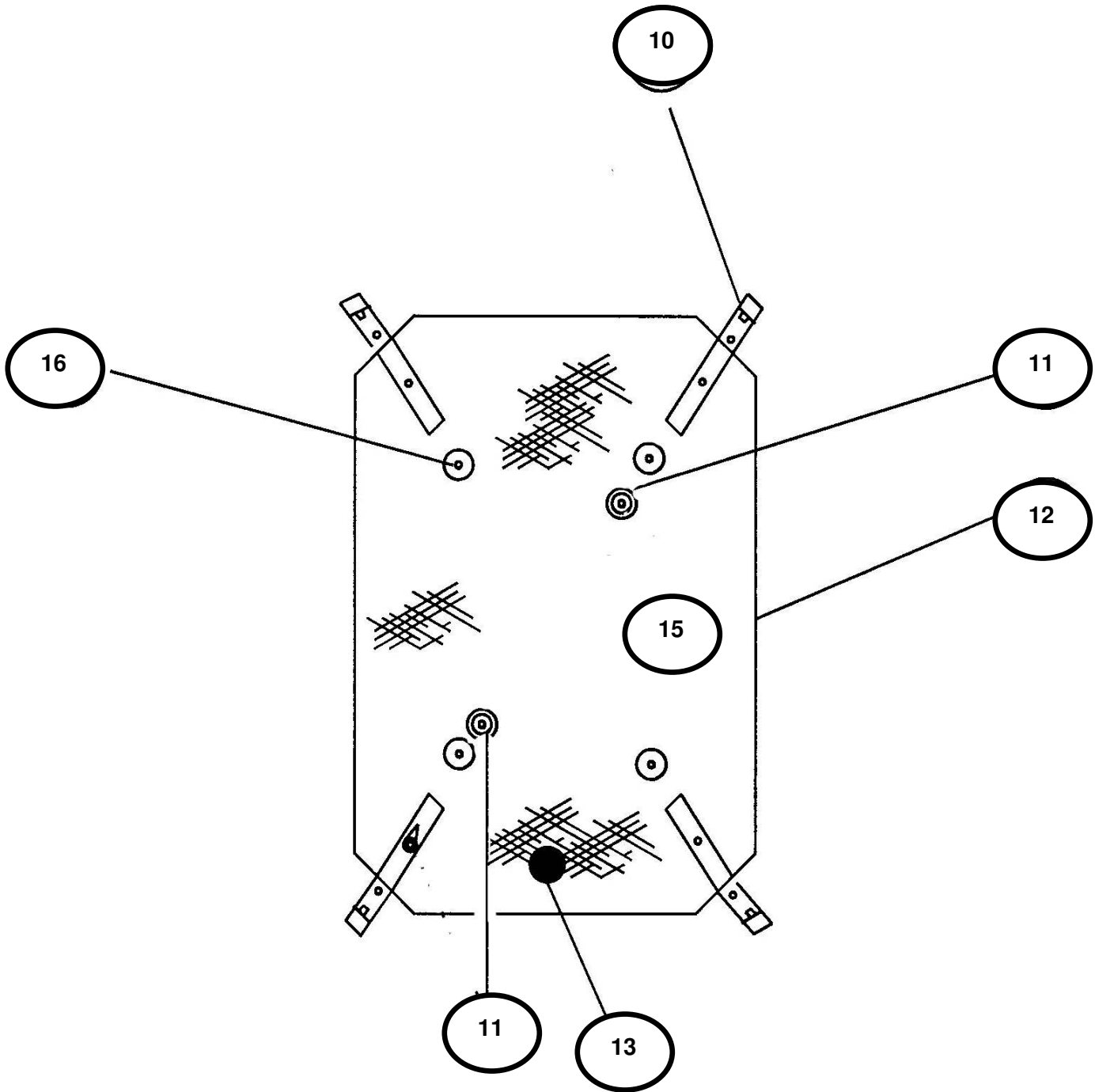

**SCHEMATIC OF UNIT (continued)**

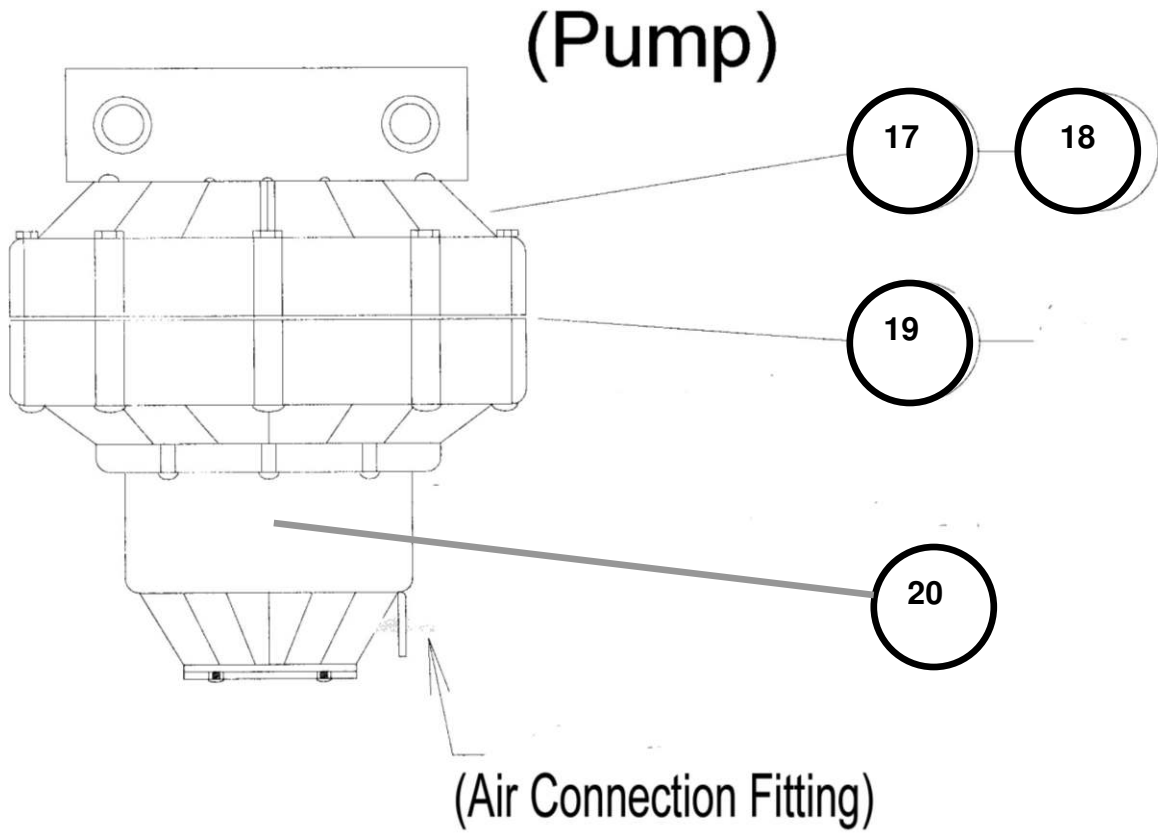

**PARTS DESCRIPTION**

<b>INDEX</b>	<b>PART #</b>	<b>DESCRIPTION</b>	<b>QUANTITY</b>
A	824552	SOLVENT SELECTION CLEAN OR USED VALVE	1
B	824547	SECURITY VALVE	1
1	824010	FILTER / REGULATOR	1
2	824547	3-Way Valve	1
3	824552	2- Way Valve	1
4	823130	COMPRESSION FITTING	1
5	823131	90° COMPRESSION FITTING	Multiple Locations
6	824560	PUSH-IN FITTING	1
7	824557	"Y" PUSH-IN FITTING	Multiple Locations
8	824632	BULKHEAD FITTING (9830 H Only)	1
9	823017	Nylon Plug	1
10	824575	SPRAY MANIFOLD	1
11	834589	STREAM NOZZLE	2
12	830124	BASIN GRILL	1
13	823102	GRILL KNOB	1
14			
15	824590	SPRAY GUN CLIP	2
16	824554	SPRAY NOZZEL	12
17	824549	PUMP	1
18	824549-R	REBUILT PUMP	1
19	824525	PUMP DIAPHRAGM SERVICE KIT	
20	824523	PUMP SPRING SERVICE KIT	1
21	824520	PUMP CHECK VALVE SERVICE KIT	1
		<b><u>OPTIONAL ACCESSORIES</u></b>	
	ECP - 5GAL	5 GALS / 20 LITERS SOLVENT CONTAINER	1
	ECP - 831004	BECCA PROTECT FILM 30" x 200' Roll – PEEL AWAY FILM	1
	831127	DECAL KIT S10A	1

**WARRANTY INFORMATION / TECHNICAL ASSISTANCE**

The Warranty of your system begins with the Certified Start-up by your local BECCA Distributor. Make sure this is completed and you receive a copy of the Certified Start-up document.

For more information, prices or technical assistance, contact your local BECCA distributor or call / fax our BECCA Care™ Numbers:

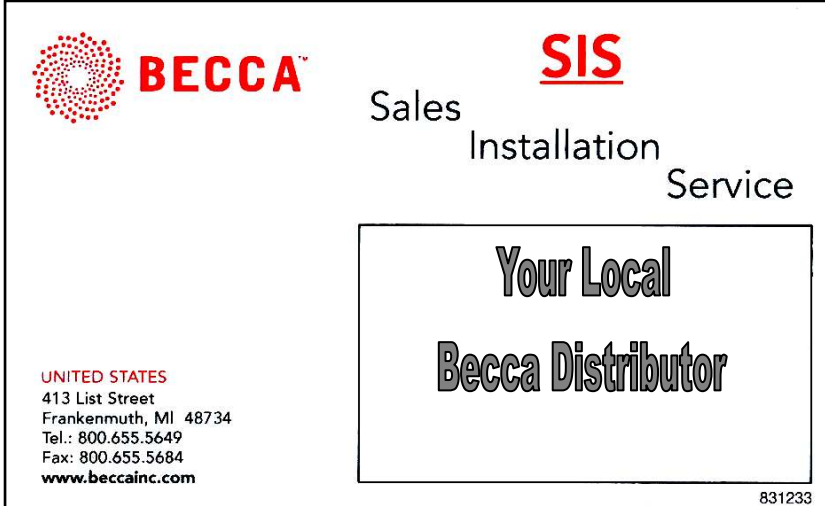

The image shows a logo for BECCA SIS. On the left is the BECCA logo, which consists of a circular pattern of red dots followed by the word "BECCA" in red. To the right of this is the text "Sales Installation Service" with "SIS" in red above it. Below the BECCA logo is contact information for the United States: "UNITED STATES", "413 List Street", "Frankenmuth, MI 48734", "Tel.: 800.655.5649", "Fax: 800.655.5684", and "www.beccainc.com". In the center, there is a box containing the text "Your Local Becca Distributor". In the bottom right corner of the entire graphic, the number "831233" is printed.

2010 Cobb International Blvd Ste H  
Kennesaw, GA 30152

Tel: (800) 655-5649

Fax: (800) 655-5684

Copyright © 2005 by BECCA Inc. All Rights Reserved